

# [320<sub>v1</sub>] Creation 30 Clic

CONDITIONS

SUBSTRATES

ACCESSORIES

INSTALLATION

## LAYING CONDITIONS

SUBSTRATE EVENNESS	Flatness requirement: < 5 mm / 2 metre ruler and < 1 mm / 20 cm ruler	Flat, clean, sound, dry and solid substrate.
STORAGE	At least 24 hours prior to installation	Store the floor covering in the room where it is going to be laid.
LAYING TEMPERATURE	+ 15°C < T < + 26°C	Ideally 20°C.
PERIMETER EXPANSION GAP	4 to 5 mm	Around the edges of the room, fixed objects and door frames. The gap must be covered by a finishing profile. Wet rooms (e.g. bathrooms): MS Polymer or PU sealant under the finishing profile.
DIVISIONS	Every 10 linear metres or surface area > 150 m <sup>2</sup>	Each closed room or premises must be considered separately. Divide the tiles/planks lengthwise by applying an adhesive (such as Gerflor Fix & Free 100) or a gap covered with a ROMUS finishing profile.
DIRECT SUNLIGHT (SUNNY AREAS, BAY WINDOWS, SKYLIGHTS, SKYDOMES, ETC.)	Floor temperature < 60°C	Loose laying is allowed as long as the ambient temperature is regulated. In order to prevent the floor temperature from reaching excessive values up to 60°C or above, direct sunlight on the floor should be obscured by curtains, blinds or other suitable protection. Otherwise, maintain the floor covering in place with a suitable adhesive (please contact the adhesive manufacturer).
VERANDA/CONSERVATORY	Prohibited	Prohibited, irrespective of the substrate.
FIRST USE	Immediately after installation	

## USAGE CONDITIONS

USAGE TEMPERATURE	+ 8°C < T < + 35°C	
STATIC LOADS	< 30 kg/cm <sup>2</sup> and < 200 kg/support	Do not use rubber end caps. Use flat (not tapered) end caps without any pattern that are suitable for PVC. Use end caps on furniture legs.
CASTOR CHAIRS	PVC-compatible castors according to EN 12529	Recommendation: protective mat beneath castor chairs.

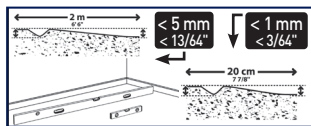

SUBSTRATE EVENNESS

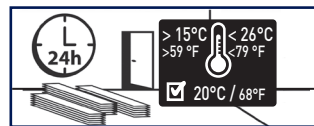

STORAGE

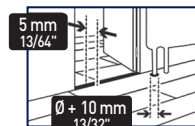

PERIMETER EXPANSION GAP

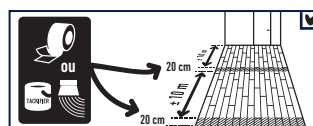
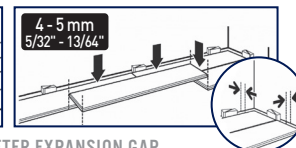

DIVISIONS

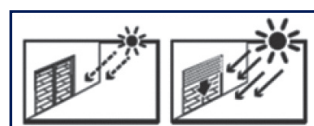

DIRECT SUNLIGHT

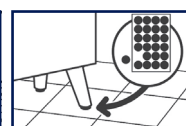

STATIC LOADS

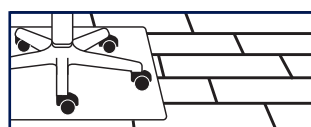
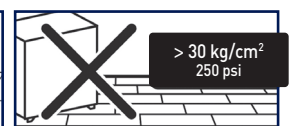

CASTOR CHAIRS



MAINTENANCE

IMPORTANT : The information in this document is valid from: 08/09/21 and is subject to change without notice. As we carry out continuous technical improvements, our customers should check with us that this document is still in force before starting any work.

**Gerflor**

# [320<sub>v1</sub>] Creation 30 Clic

CONDITIONS	<b>SUBSTRATES</b>	ACCESSORIES	INSTALLATION
------------	-------------------	-------------	--------------

SUBSTRATE		CONDITIONS For installing this floor covering
Concrete floor, painted concrete, levelling compound, cement based screed, anhydrite (calcium sulphate)-based screed	✓	Cement based substrate: < 7 % CCM, 92 % RH - Anhydrite-based substrate: < 1 %. If necessary, prepare the support and apply a smoothing compound to eliminate any irregularities
Ceramic tiles	✓	If tile joints < 5 mm wide and < 2mm deep, and no unevenness. Otherwise, apply a grouting product or levelling compound
Glued compact PVC / rubber / linoleum floor coverings	✓	After examination and repair depending on the condition of the floor covering. If more than 10% is in bad condition, complete removal is necessary followed by new substrate preparation
Glued foam backed PVC floor coverings	!	In residential areas only. After examination and repair depending on the condition of the floor covering. if more than 10% is in bad condition, complete removal is necessary followed by new substrate preparation.
Textile floor covering (carpet) / textile-backing PVC floorings	✗	Prohibited
Vinyl asbestos tiles	✓	Refer to Gerflor's Technical Guide for Overlaying Asbestos Floors
Acoustic underlayers	!	Only Gerflor underlayers Silence Plus 19 dB (in residential area classified max CEN 23), Gerflor acoustic 15 dB and Gerflor Acoustic Plus. Refer to corresponding installation guidelines.
Glued parquet / laminated floor /floating parquet or wood based panels	✗	Prohibited (complete removal)
OSB	✗	Complete removal or lining boards
Wood-based panel flooring on joists or battens / parquet nailed on battens ventilated underneath	✓	Allowed
Water reversible underfloor heating	✓	Allowed
Underfloor heating with circulating water, max temperature 28°C	✓	Allowed
Radiant electric underfloor heating	!	Gluing mandatory

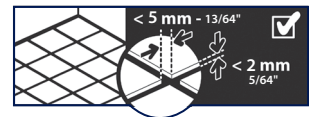
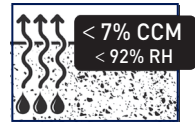

The preparation of the substrate must comply with the current relevant standards in the country of use.  
For any information on product properties and usages, please refer to its technical datasheet: [www.gerflor.com](http://www.gerflor.com).

# [320<sub>v1</sub>] Creation 30 Clic

CONDITIONS

SUBSTRATES

**ACCESSORIES**

INSTALLATION

<p><b>TOOLS</b></p>	<p>Cutter - Tape measure - Metal ruler - Non-rebound mallet - Ref.: 94964 from ROMUS - LVT-Clic roller -Ref.: 93153 from ROMUS Mitre shears - Reference ROMUS: 93401 / JANSER: 237 530 000</p>
<p><b>ADHESIVES FOR DIRECT SUNLIGHT AREAS</b></p>	<p>Refer to adhesive manufacturers recommendations</p>
<p><b>DIVISIONS</b></p>	<p><b>FIX&amp;FREE 100 and ROMUS accessories</b></p>
<p><b>ACOUSTIC UNDESLAYER</b></p>	<p>Gerflor Acoustic 15 dB - Ref.: 17980001 - See Installation Guidelines [330] Gerflor Silence Plus 19 dB - Ref.: 59490001 - See Installation Guidelines [331] Gerflor Acoustic Plus - Ref.: 074040001 - See Installation Guidelines [332]</p>
<p><b>FINISHES</b></p>	<p>Skirting Design - Ref.: 6086 / Skirting Design - MDF - Ref.: 5947 - See Installation Guidelines [504A] and [504B]. Door threshold: refer to Romus catalogue. Wet rooms (e.g. bathrooms): MS Polymer or PU sealant.</p>

# [320<sub>v1</sub>] Creation 30 Clic

CONDITIONS

SUBSTRATES

ACCESSORIES

INSTALLATION



The floor covering should be examined prior to installation for any visible defects. The flooring must belong to the same production batch. If there are any visible defects, please notify GERFLOR and do not begin installation without its prior approval.

## LAYOUT

- Mix the planks/tiles from several different boxes from the same series.

- The planks/tiles must be oriented in the direction of light or in the direction of traffic.

- Perimeter expansion gap: 4-5 mm. At room edges, fixed objects and door threshold. The gap must be covered by a finishing profile. Wet rooms (e.g. bathrooms): MS Polymer or PU sealant under the finishing profile.

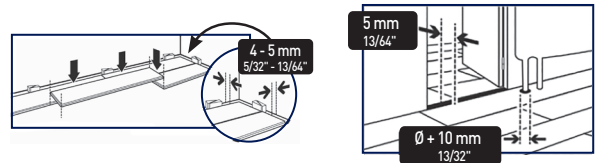

- Start laying the planks/tiles in a corner of the room. Move backwards as you lay, with the tongues facing towards you.

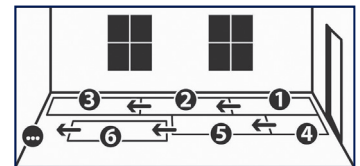

- Offset each row ideally by one third of a plank length, or lay them with «hidden joints». In this case, offset the planks by at least 25 cm, and start the second row with the offset from the last plank of the previous row. Avoid small cuts at the end of the rows.

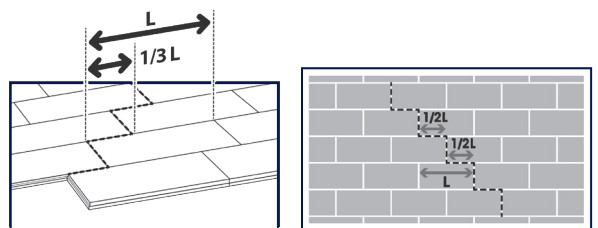

Lay the tiles in staggered joint (offset by half a tile).

- In standard sections, the width of the planks/tiles must be  $> 1/3$  plank or  $1/2$  tile.

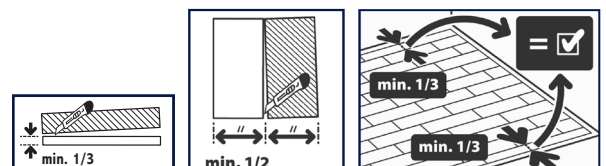

- At the end of the rows, the length of planks/tiles must be  $> 25$  cm, particularly at the entrances and doorways.

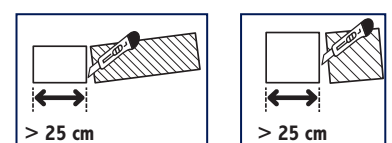

# [320<sub>v1</sub>] Creation 30 Clic

CONDITIONS

SUBSTRATES

ACCESSORIES

INSTALLATION

## INTERLOCKING AND CUTTING OUT

- Carefully position the tongue over the groove.



- Strike the plank/tile with a plastic hammer starting from the corner between short edge/long edge.



- Finish the interlocking by rolling with a LVT clic roller.

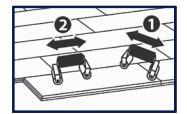

- Make sure that there is no unevenness between planks/tiles.

Incorrect interlocking may lead to imperfect alignment, gaps between tiles/planks, or clic breakage. If necessary, re-adjust the alignment using a wooden block and a plastic hammer.

- Peripheral cutting using the overlapping method.



- Cutting at the base of door frames.

Use mitre shears (possibly with high leverage).  
ROMUS ref: 93401 / JANSER ref: 237 530 000.

