

1

AREA OF USE

2

SUBSTRATES

3

INSTALLATION

4

FIRST USE

5

MAINTENANCE

*Residential use, temperature-regulated interior room + 10°C < T < + 30°C.*

*We recommend having **temperature regulation** (air conditioning, etc.) or **preventing direct sunlight** from reaching the material (curtains, blinds, etc.)*

*Installation on areas exposed to sunlight, in front of bay windows, skylights, or fireplaces (significant temperature variation) **will require glueing.***

***This floor covering cannot be laid on verandas.***

*IMPORTANT: The information in this document is valid from: 01/01/2019 and is subject to change without notice. In the face of continuous technical improvements, before starting any work, our customers should check with us that this document is still in force.*

1

2

3

4

5

AREA OF USE

SUBSTRATES

INSTALLATION

FIRST USE

MAINTENANCE

### 1. GENERAL

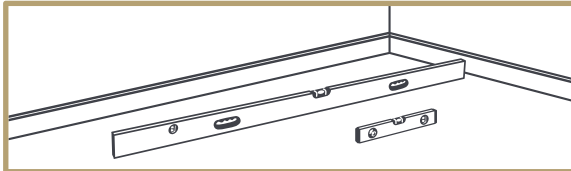

The flooring must be laid on a flat, clean, sound, dry and solid substrate.



The moisture content must not exceed 7% with a carbide moisture test.

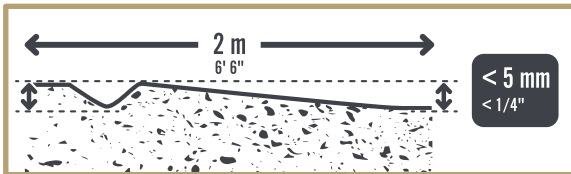

The flatness tolerance must be < 5 mm under a 2 meters straight edge.

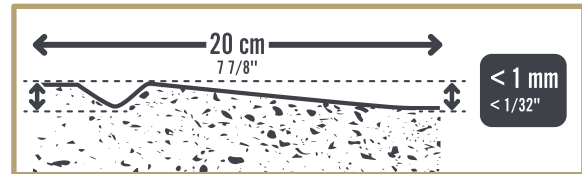

The substrate must not have any uneven areas > 1 mm every 20 cm.

### 2. RECOMMENDATIONS BY SUBSTRATE TYPE

#### Substrate

#### Conditions

Ceramic Tiles	✓	If joint < 4 mm width < 1 mm depth.
Concrete Floor, Painted Concrete, Levelling Concrete, Toppings, Liquid, Cement Screeds	✓	If necessary, apply a levelling compound to eliminate any surface irregularities.
Anhydrite	✓	If humidity < 0,5 %.
Compact Vinyl	✓	
Acoustic Vinyl , Carpet , Laminate	✗	Removal mandatory. If necessary, apply a levelling compound to eliminate any surface irregularities.
Wood	✓	If not glued, nailed onto spaced battens. If glued, removal mandatory. If the existing floor is too flexible, cover with 19 mm lining board and fix down.
Oriented Strand Board	✗	Cover with 19 mm lining board and fix down.
Underlayer	✓	Only Gerflor Acoustic and Silence Ultra underlays are permitted. Installation on any other underlay is not possible.

# SENSO CLIC

PREMIUM

1

AREA OF USE

2

SUBSTRATES

3

INSTALLATION

4

FIRST USE

5

MAINTENANCE

## 1. BEFORE LAYING

All floor and wall coverings should be examined prior to installation for any visible defects.

To ensure colour uniformity, the floor covering laid in any one room should be from the same manufacturing batch, marked on the packaging.

The room temperature during installation must be between 15°C and 26°C.

The planks or tiles must be stored in the room for 24 h before installation.

## 2. TOOLS



Utility knife



Tape measure



Metal Ruler



Non-rebound mallet



Cut-resistant gloves

## 3. LAYING DIRECTION

The planks / tiles must be oriented towards the wall with the main window, or lengthwise.

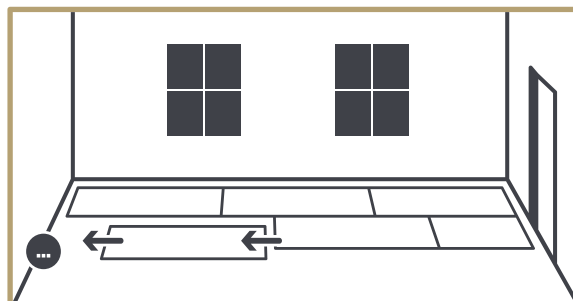

1

2

3

4

5

AREA OF USE

SUBSTRATES

INSTALLATION

FIRST USE

MAINTENANCE

### 4. FIRST ROW

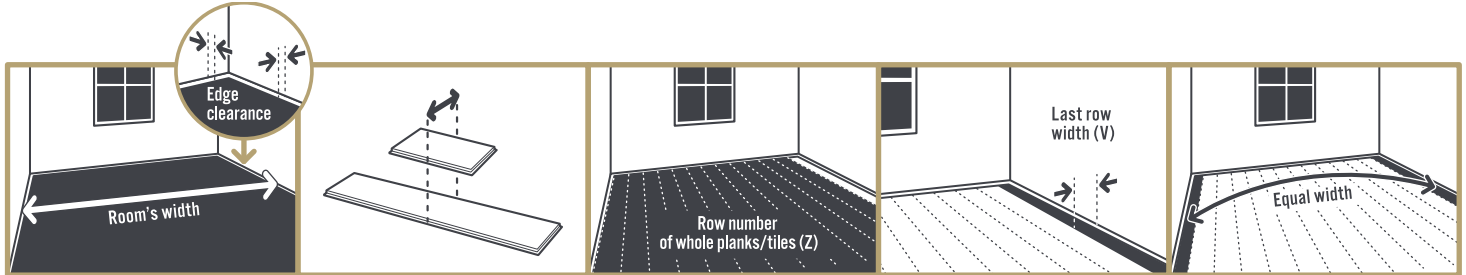

$$X = \text{room's width} - (\text{edge} \times 2)$$

$$Y = X / \text{plank's width}$$

$$Z = \text{round } Y \text{ to the lower integer}$$

$$W = Y - Z$$

$$V = W \times \text{plank's width}$$

$$(\text{plank's width} + V) / 2 = \text{size of the first and latest row}$$

#### Example:

My room is 2 m wide, 2000 mm.

I know, I have to allow an edge clearance of 4 mm.

$$X = 2000 - (4 \times 2) = 1992$$

My plank is 20,4 cm wide, 204 mm.

$$Y = 1992 / 204 = 9.7$$

$$Y = 9.7$$

$$\text{so } Z = 9$$

$$W = 9.7 - 9 = 0.7$$

$$V = 0.7 \times 204 = 142.8$$

So, the width of the latest row has to be 14.28 cm.

$$(204 + 142.8) / 2 = 173.4$$

Or, the sizes of first and latest row has to be 17.34 cm to be the same.

### 5. INSTALLATION

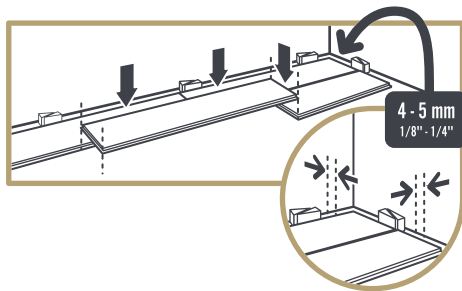

**TIP:** Use offcuts of planks or tiles as spacing wedges.

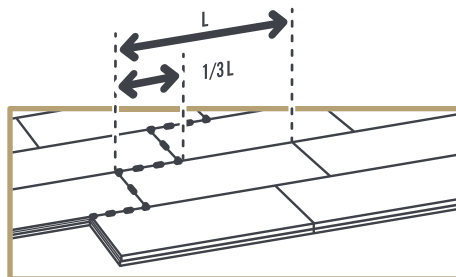
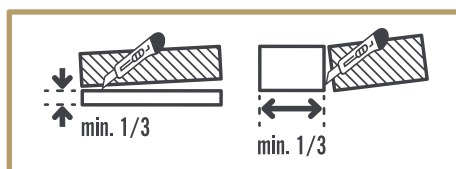

Start laying in a corner of the room. A maximum edge clearance of 4 to 5 mm should be left around the edge of the room and around fixed objects.

Planks must be staggered in a brick pattern.

Tiles must be offset by half.

1

2

3

4

5

AREA OF USE

SUBSTRATES

INSTALLATION

FIRST USE

MAINTENANCE

### 6. ASSEMBLY

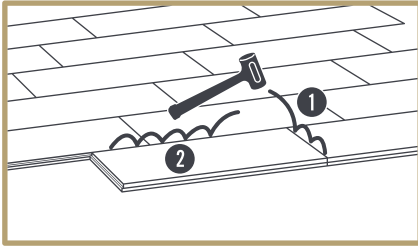

The planks / tiles are interlocked by striking with a mallet, starting with the short edge.

### 7. CUTTING AT THE END OF A ROW

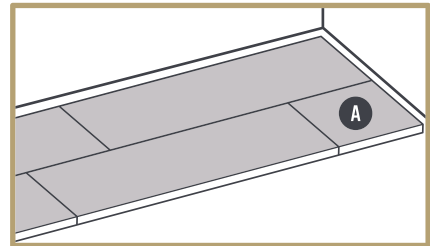
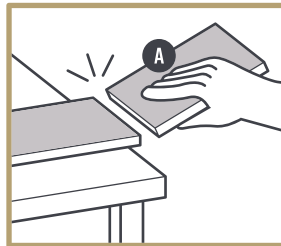
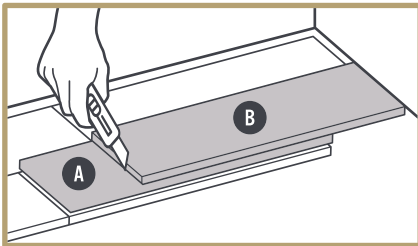

### 8. LAYING RECOMMENDATIONS

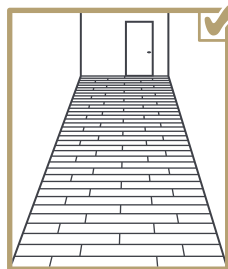
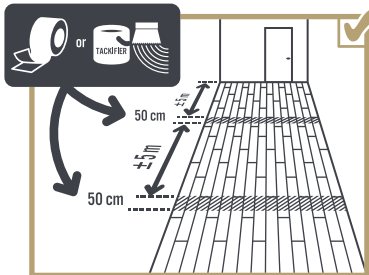

Up to 150 m<sup>2</sup>, no sticking down required.

In a corridor more than 5 m long, it is recommended to stick partially over 20 cm using double-sided adhesive tape.

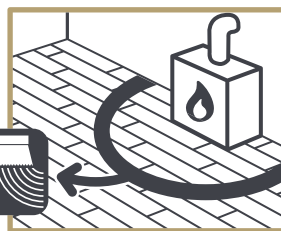
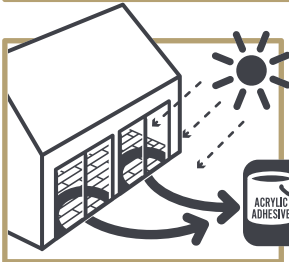

In front of a bay window, fireplace and any other source of excessive heat, planks / tiles should be stuck down over 50 cm to 1 m.

In bathrooms we recommend applying a silicon sealant around the edges of baths and showers.

1

AREA OF USE

2

SUBSTRATES

3

INSTALLATION

4

FIRST USE

5

MAINTENANCE

The flooring can be used **as soon as it is laid**.

Take precautions before use of heavy furniture and chairs with castors (felt caps or protective mats) –  
Do not use rubber feet (risk of yellow/rust stains).

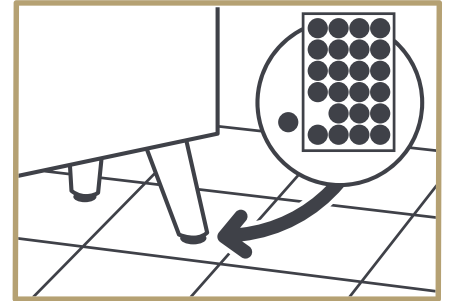
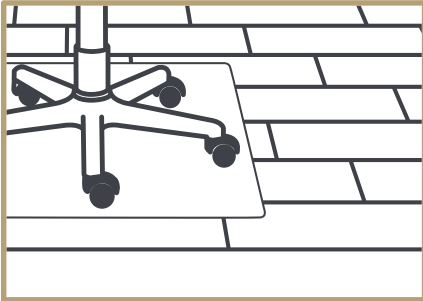

1	2	3	4	5
AREA OF USE	SUBSTRATES	INSTALLATION	FIRST USE	MAINTENANCE

1.

Cuts are made using a utility knife:

- With a straight blade, make one or more cuts along the surface of the plank / tile.
- Bend the plank / tile to snap it.

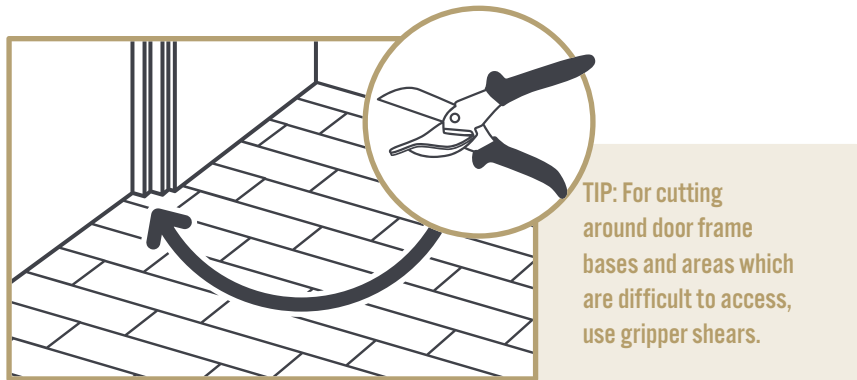

2.

To replace a plank / tile:

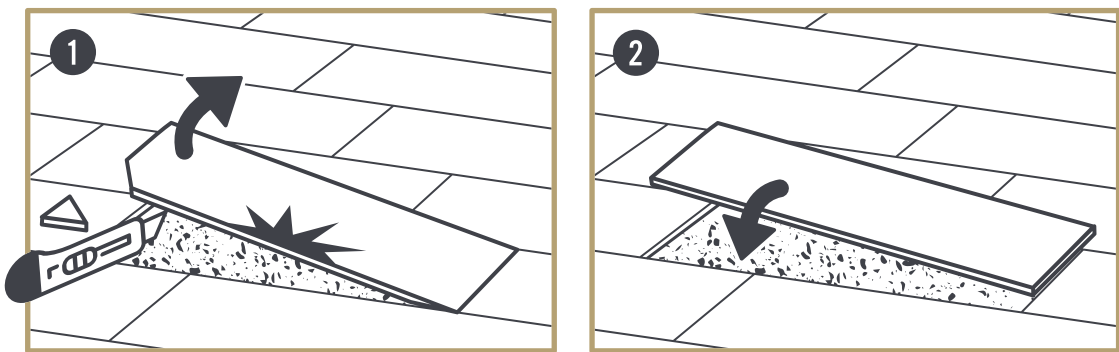

1 Cut into the corner using the utility knife, remove the plank / tile.

2 Then insert a replacement plank / tile and assemble.