

1

AREA OF USE

2

SUBSTRATES

3

INSTALLATION

4

FIRST USE

5

MAINTENANCE

Residential use, temperature-regulated interior room + 8 < T < + 35°C.

Loose laying is allowed as long as the ambient temperature is regulated and the floor temperature doesn't exceed 60°C

This floor covering cannot be laid on verandas.

IMPORTANT: The information in this document is valid from: 01/06/2021 and is subject to change without notice. In the face of continuous technical improvements, before starting any work, our customers should check with us that this document is still in force.

1

2

3

4

5

AREA OF USE

SUBSTRATES

INSTALLATION

FIRST USE

MAINTENANCE

1. GENERAL

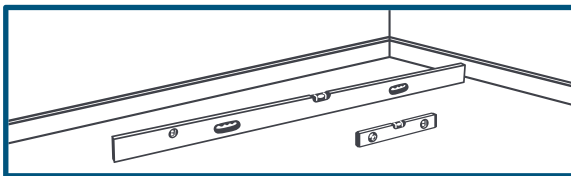

The flooring must be laid on a flat, clean, sound, dry and solid substrate.



The moisture content must not exceed 7% with a carbide moisture test.

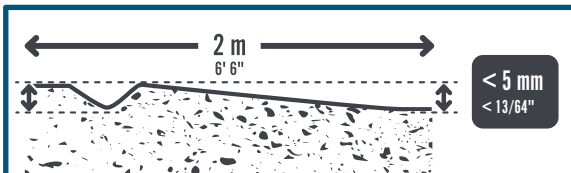

The flatness tolerance must be < 5 mm under a 2 meters straight edge.

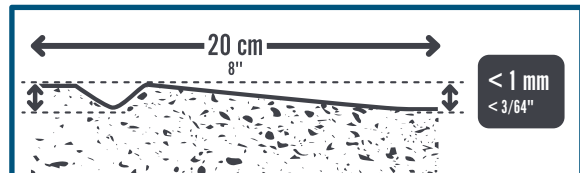

The substrate must not have any uneven areas > 1 mm every 20 cm.

2. RECOMMENDATIONS BY SUBSTRATE TYPE

Substrate

Conditions

Substrate	Conditions
Ceramic Tiles	✓ If joint < 5 mm width < 2 mm depth. Otherwise, apply a grouting product or levelling compound to eliminate irregularities.
Concrete Floor, Painted Concrete, Levelling Concrete, liquid cement-based screed	✓ Substrate moisture content < 7%. If necessary, apply a levelling compound to eliminate any surface irregularities.
Anhydrite	✓ Substrate moisture content < 0,5 %.
Compact Vinyl	✓
Acoustic Vinyl, Carpet, Laminate	✗ Removal mandatory. If necessary, apply a levelling compound to eliminate any surface irregularities.
Wood	✓ If not glued and nailed onto spaced battens. If glued, removal mandatory. If the existing floor is too flexible, cover with 19 mm lining board and fix down.
Oriented Strand Board	✗ Cover with 19 mm lining board and fix down.
Underlayer	✓ Only Gerflor acoustic underlayers Silence Plus 19 dB (in residential area only) and Gerflor acoustic 15dB. Refer to corresponding installation guidelines. Installation on any other underlay is not possible.
Water underfloor heating	✓ Reversible underfloor heating or underfloor heating with circulating water, max temperature 28°C.

SENSO CLIC

1

AREA OF USE

2

SUBSTRATES

3

INSTALLATION

4

FIRST USE

5

MAINTENANCE

1. BEFORE LAYING

All floor and wall coverings should be examined prior to installation for any visible defects.

To ensure colour uniformity, the floor covering laid in any one room should be from the same manufacturing batch, marked on the packaging.

The room temperature during installation must be between 15°C and 26°C.

The planks or tiles must be stored in the room for 24 h before installation.

2. TOOLS



Utility knife



Tape measure

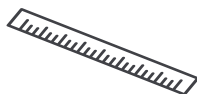

Metal Ruler



Non-rebound mallet



Cut-resistant gloves

3. LAYING DIRECTION

The planks / tiles must be oriented towards the wall with the main window, or lengthwise.

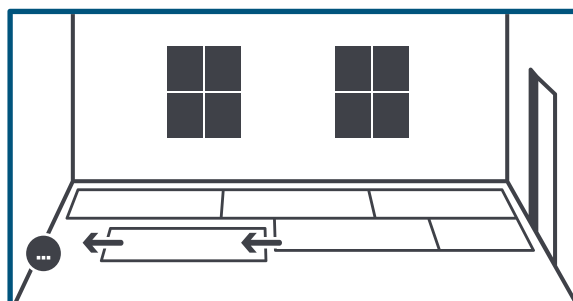

1	2	3	4	5
AREA OF USE	SUBSTRATES	INSTALLATION	FIRST USE	MAINTENANCE

4. FIRST ROW

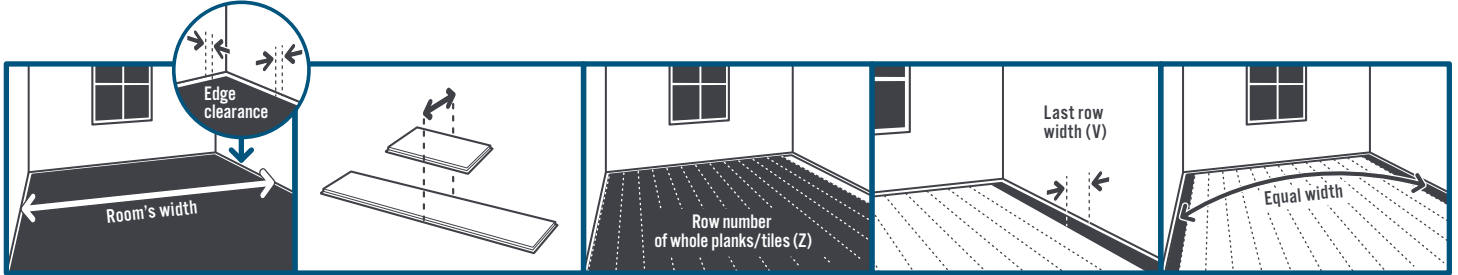

$$X = \text{room's width} - (\text{edge} \times 2)$$

$$Y = X / \text{plank's width}$$

$$Z = \text{round } Y \text{ to the lower integer}$$

$$W = Y - Z$$

$$V = W \times \text{plank's width}$$

$$(\text{plank's width} + V) / 2 = \text{size of the first and latest row}$$

Example:

My room is 2 m wide, 2000 mm.

I know, I have to allow an edge clearance of 4 mm.

$$X = 2000 - (4 \times 2) = 1992$$

My plank is 20,4 cm wide, 204 mm.

$$Y = 1992 / 204 = 9.7$$

$$Y = 9.7 \text{ so } Z = 9$$

$$W = 9.7 - 9 = 0.7$$

$$V = 0.7 \times 204 = 142.8$$

So, the width of the latest row has to be 14.28 cm.

$$(204 + 142.8) / 2 = 173.4$$

Or, the sizes of first and latest row has to be 17.34 cm to be the same.

5. INSTALLATION

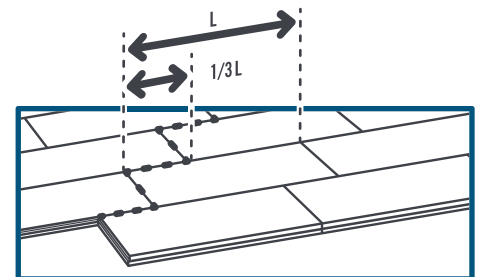
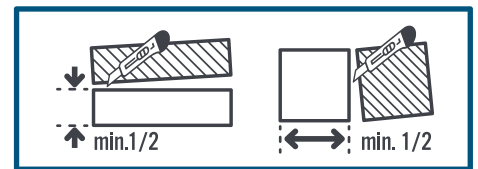
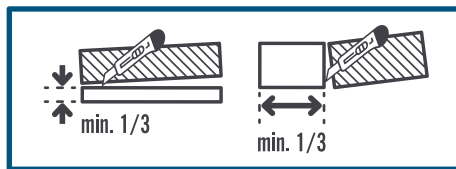
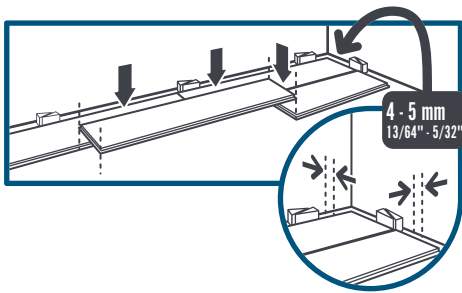

TIP: Use offcuts of planks or tiles as spacing wedges.

Start laying in a corner of the room.

Move backwards as you lay the planks, with the tongues facing towards you.

A maximum edge clearance of 4 to 5 mm should be left around the edge of the room and around fixed objects.

Planks must be offset by at least 25 cm, ideally 1/3 of plank.

Tiles must be offset by half.

1

2

3

4

5

AREA OF USE

SUBSTRATES

INSTALLATION

FIRST USE

MAINTENANCE

6. ASSEMBLY

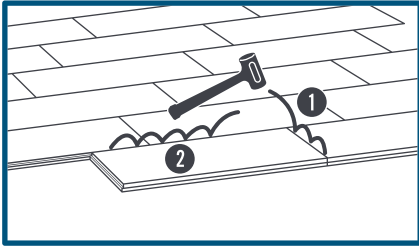

The planks / tiles are interlocked by striking with a mallet, starting with the short edge.

7. CUTTING AT THE END OF A ROW

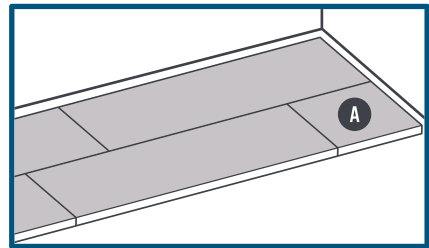
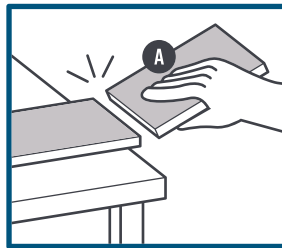
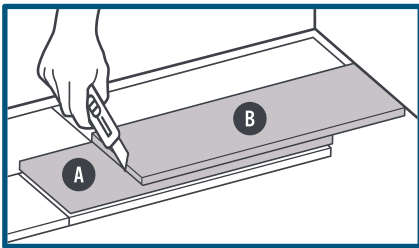

8. LAYING RECOMMENDATIONS

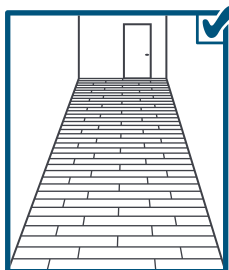
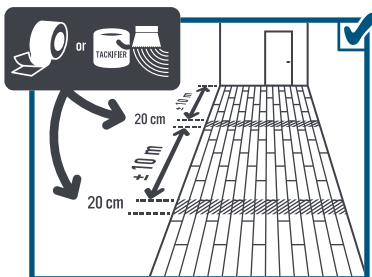

Up to 150 m², no sticking down required.

In a corridor more than 10 m long, it is recommended to stick partially over 20 cm using double-sided adhesive tape.

In bathrooms we recommend applying a silicon sealant around the edges of baths and showers.

1

AREA OF USE

2

SUBSTRATES

3

INSTALLATION

4

FIRST USE

5

MAINTENANCE

*The flooring can be used **as soon as it is laid**.*

Take precautions before use of heavy furniture and chairs with castors (felt caps or protective mats) – Do not use rubber feet (risk of yellow/rust stains).

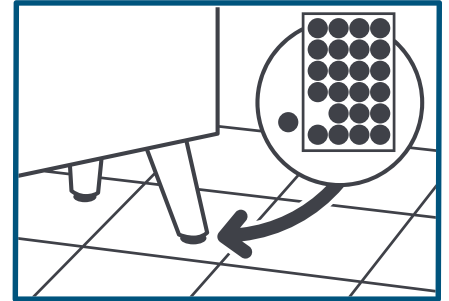
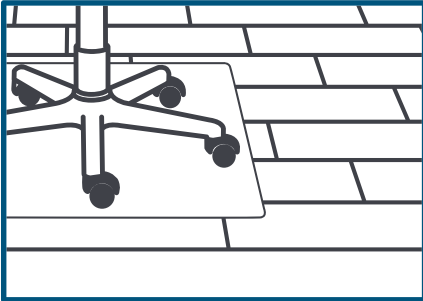

1	2	3	4	5
AREA OF USE	SUBSTRATES	INSTALLATION	FIRST USE	MAINTENANCE

1.

Cuts are made using a utility knife:

- With a straight blade, make one or more cuts along the surface of the plank / tile.
- Bend the plank / tile to snap it.

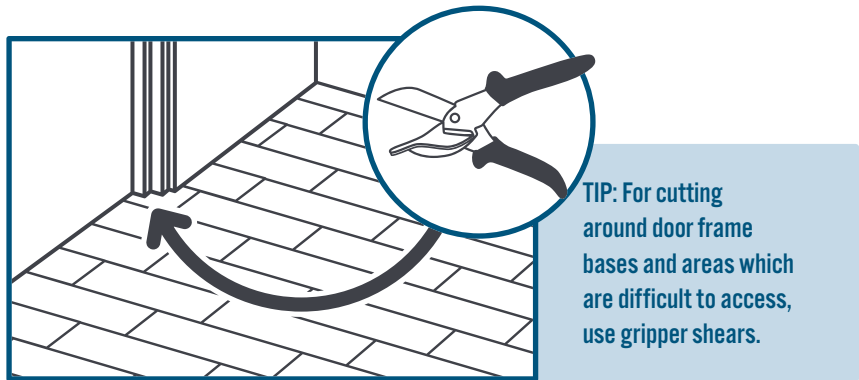

2.

To replace a plank / tile:

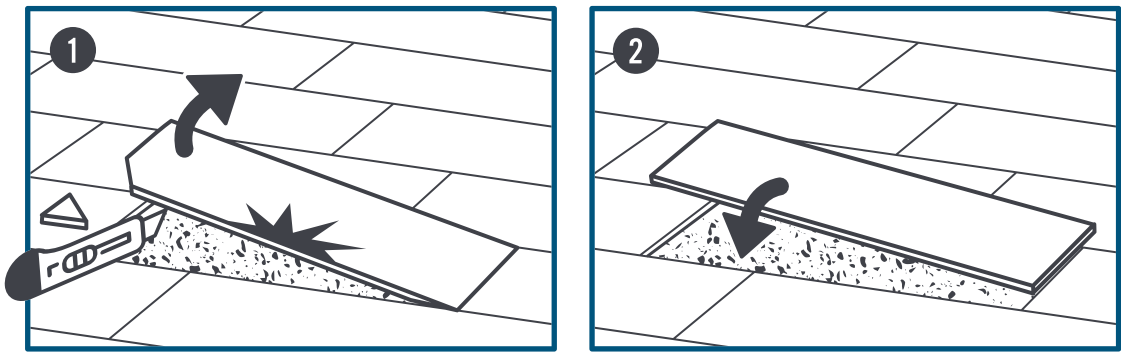

Cut into the corner using the utility knife, remove the plank / tile.

Then insert a replacement plank / tile and assemble.