

## [502A] COVING SYSTEM WITHOUT FINISHING PROFILE

Maximum 15 cm high

Gluing skirting is done with no solvent base adhesive or a one-component PU contact adhesive or special double side tape adhesive in agreement with the adhesive manufacturer.

We do not recommend solvent-based neoprene glue.

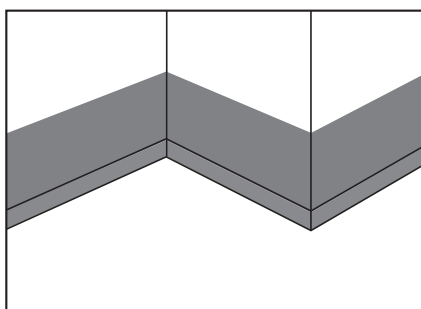

Draw a line at the height defined for the back in baseboard.  
- Draw a line on the ground at 15 or 20 mm chosen form of support.  
- Apply glue or double-sided tape.

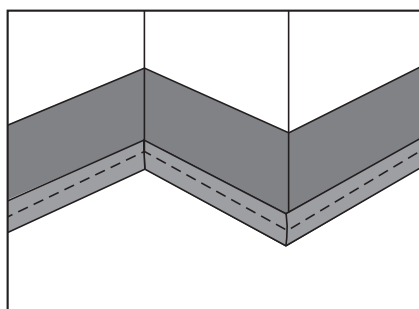

- Apply the coving .  
- Apply adhesive or tape again on the coving.

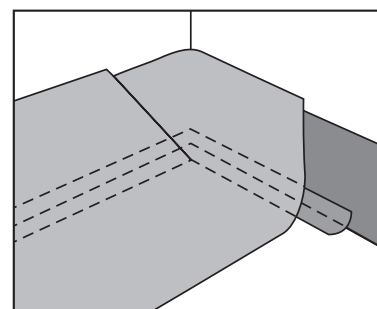

Lay, glue and cut the coating on the coving For the inside angle , cut the product at 45°...

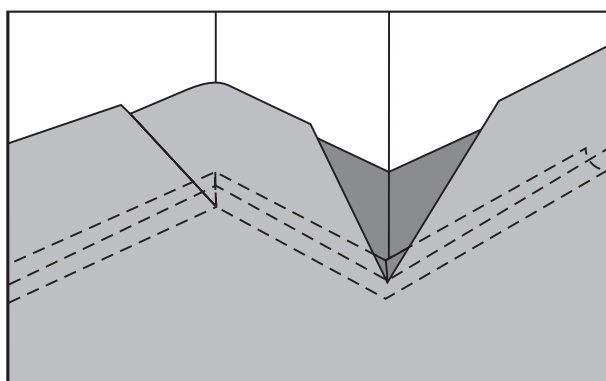

...and on the inside angle, create a V cut (Butterfly cut).

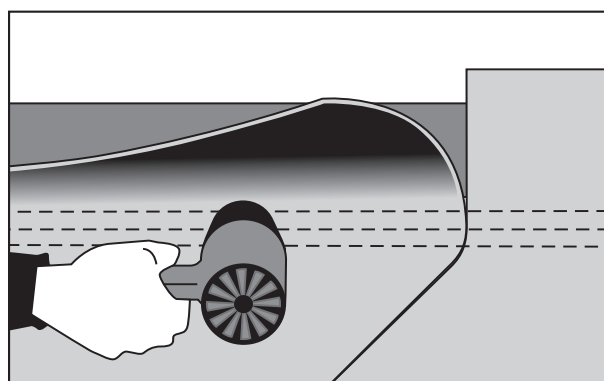

In order to facilitate the implementation of the coating on the coving and in the corners, we advise you to heat the material with a heat gun.

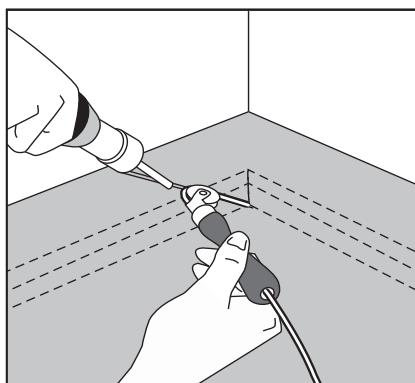

Welding in the angles with a weld roller or a speed nozzle .

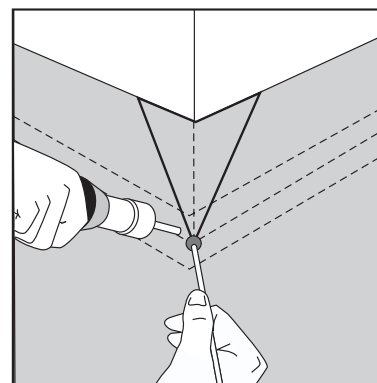

Finish the angle with a pressure ball.

[502A] COVING SYSTEM WITHOUT FINISHING PROFILE

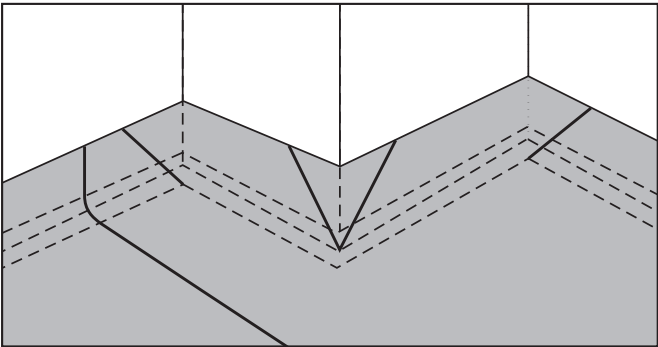

Weld on inside and outside angle and on the coving.

TOOLS FOR COVING SYSTEM

We recommend using the Rapid Ultra curved nozzle:

TOOLS	JANSER	ROMUS
Rapid Ultra curved nozzle	224 800 013	95028

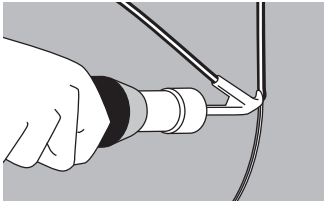

We recommend a trimmer designed for skirting lifts:

TOOLS	ROMUS
Trimmer designed for skirting lifts	95103

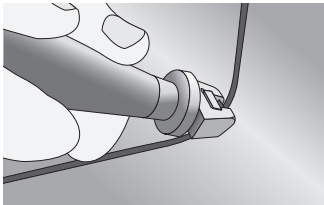
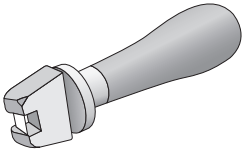

FINISHING

Once the piece is finished, strongly press the upper part of the flooring up to the baseboard.

To avoid any ungluing part caused by water infiltration or shocks, we recommend applying:

**Either a finishing mastic** on the edge of the material (MS Polymer sealant or PU),

**Either a finishing profile.**

(See Document [503] FINISHING)

